

TYPICAL STREET

REFERENCE DOCUMENT – ORDINANCE 4, EXHIBIT B, SECTION A-1: ...

TENAJA COMMUNITY SERVICES DISTRICT		
TENAJA COMMUNITY SERVICES DISTRICT	SHORT LOCAL OR CUL-DE-SAC STREET	SCALE: N.T.S. DRAWING NO. SHT 1 OF SHT 3
DATE: <u>4-20-07</u>		

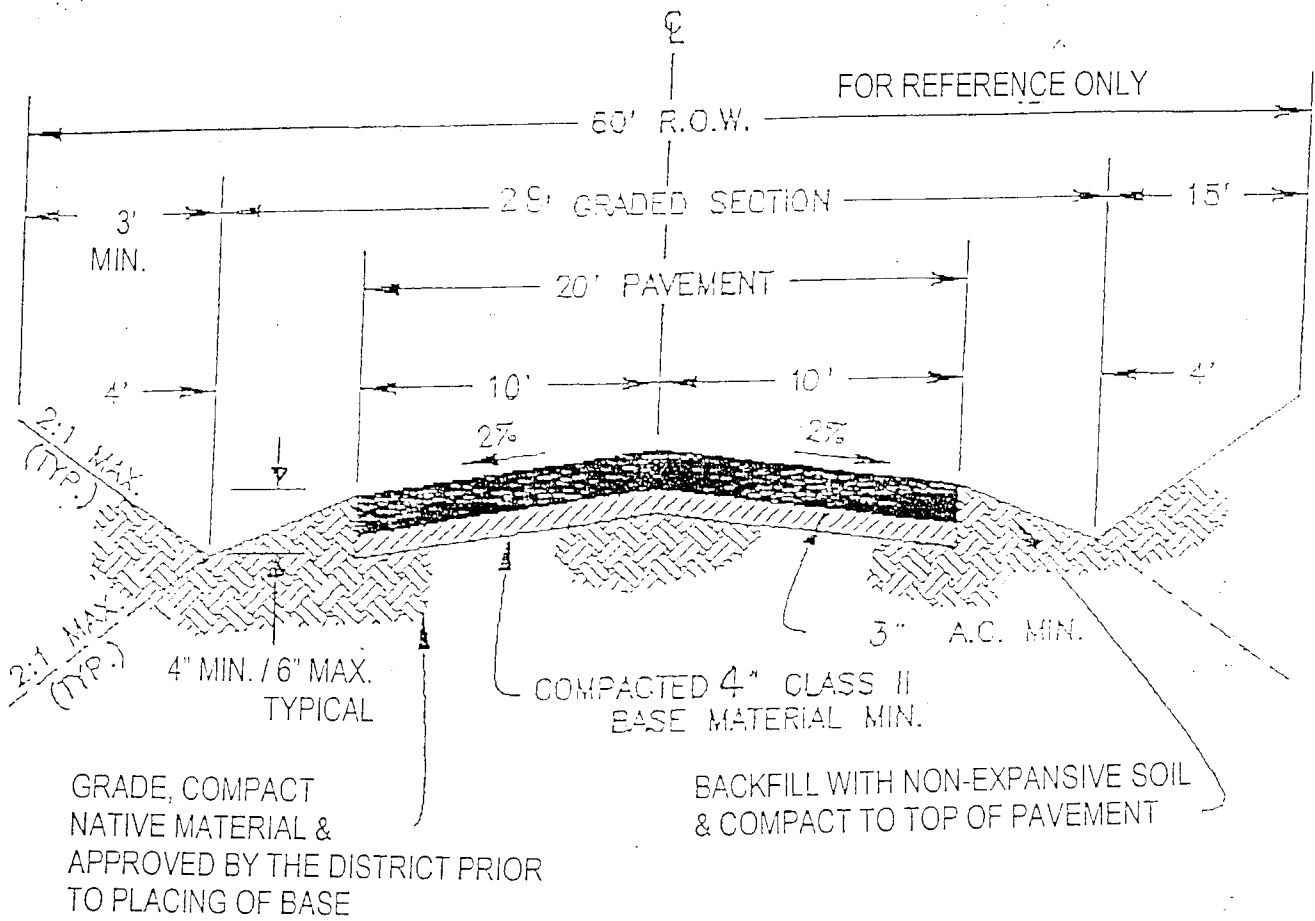

TYPICAL STREET

REFERENCE DOCUMENT - ORDINANCE 4, EXHIBIT B, SECTION A-2

TENAJA COMMUNITY SERVICES DISTRICT		
TENAJA COMMUNITY SERVICES DISTRICT	<b>GENERAL LOCAL OR SECONDARY STREET</b>	SCALE: N.T.S. DRAWING NO.
DATE: <u>4-20-07</u>		SHT 2 OF SHT 3

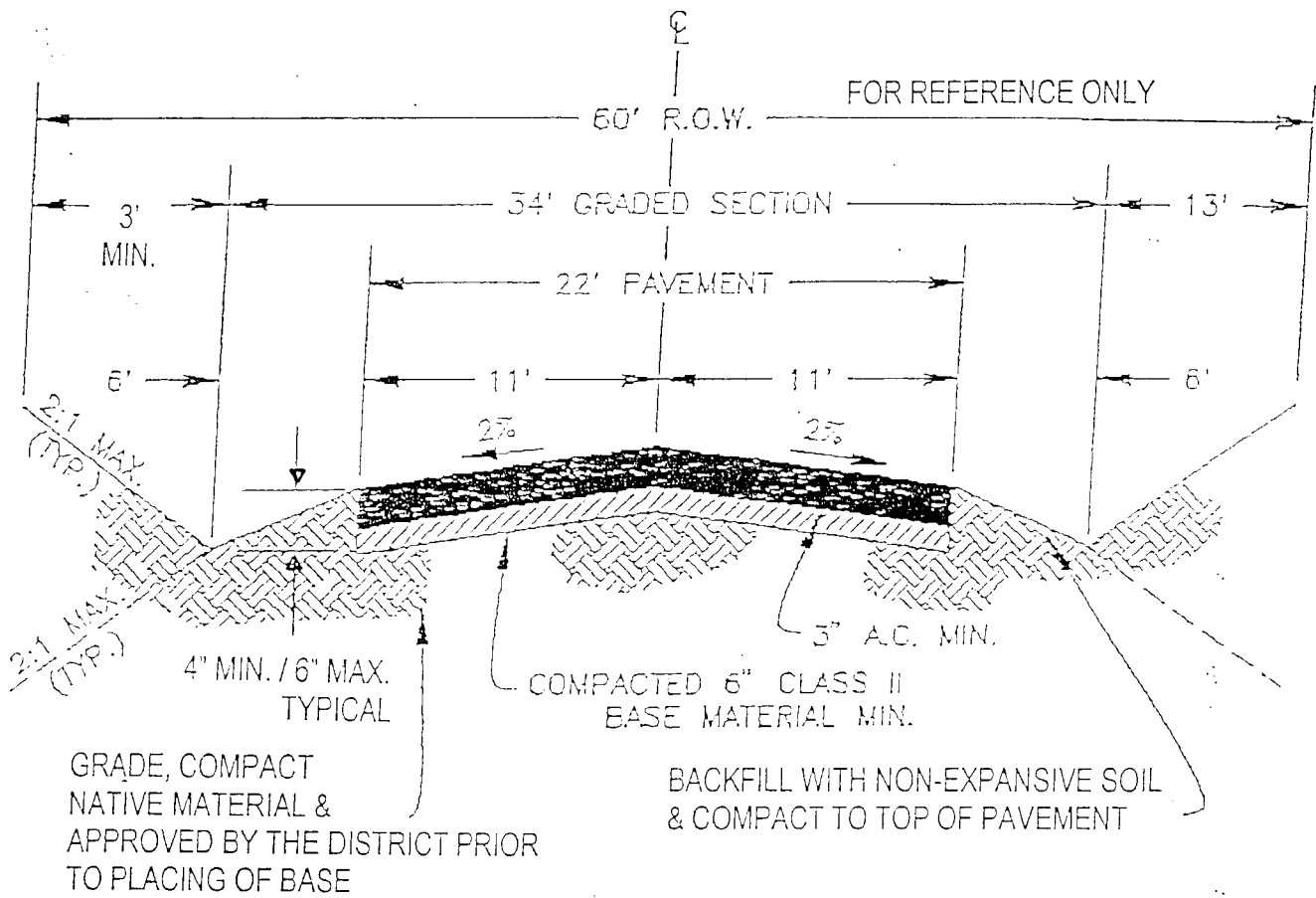

TYPICAL STREET

REFERENCE DOCUMENT – ORDINANCE 4, EXHIBIT B, SECTION A-3

TENAJA COMMUNITY SERVICES DISTRICT		
TENAJA COMMUNITY SERVICES DISTRICT	<b>COLLECTOR OR PRIMARY STREET</b>	SCALE: N.T.S. DRAWING NO.
DATE: 4.20.07		SHT 3 OF SHT 3

TENAJA COMMUNITY SERVICES DISTRICT  
EXHIBIT "C"

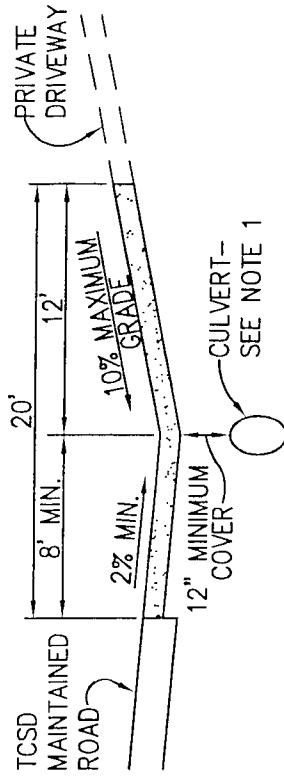

**SECTION 'A-A'**

NOT TO SCALE

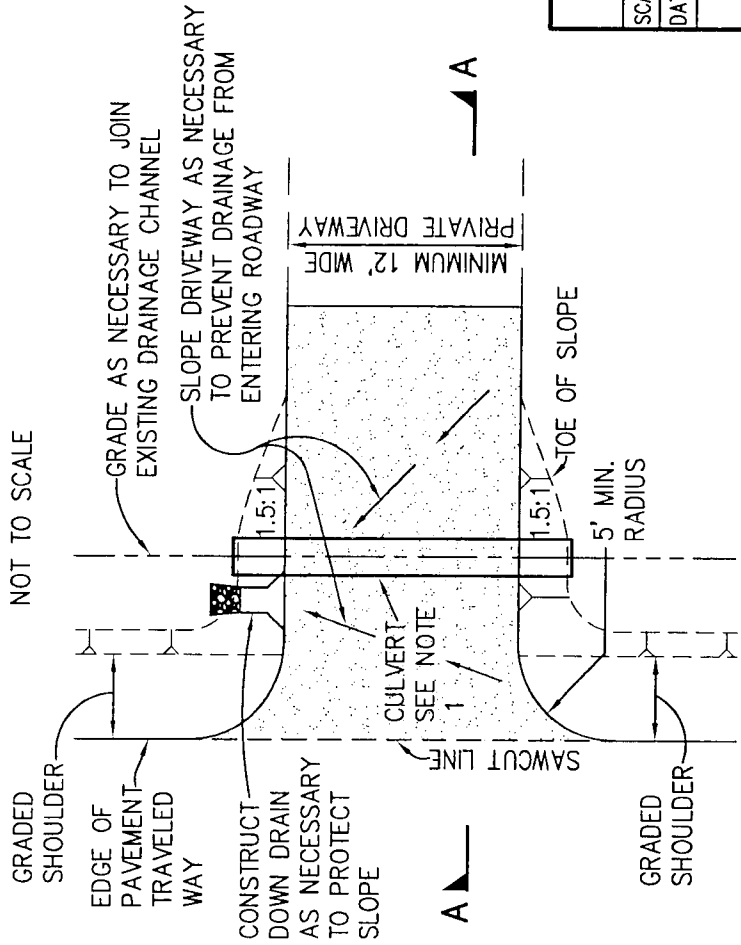

**NOTES:**

1. CULVERT SHALL BE 12 GA. 18" C.M.P. OR 22"x18" C.M.P.A. (MIN.).
2. DRIVEWAY SURFACING SHALL BE 3" THICK (MIN.) A.C. OR 4" P.C.C. ON COMPACTED SOIL.
3. REQUIREMENT FOR CULVERT DETERMINED BY TCSD.
4. A.C. CURB, IF PRESENT, MUST BE SAWCUT TO PROVIDE A 3' MINIMUM TRANSITION FROM 6" CURB HEIGHT TO 1-1/2" LIP ACROSS DRIVEWAY APRON. APRON MUST BE CONSTRUCTED TO PREVENT ROADWAY DRAINAGE FROM ENTERING DRIVEWAY.
5. TRANSITION FROM A.C. SWALE - SEE TCSD STD. DRAWING #113.

TENAJA COMMUNITY SERVICES DISTRICT

SCALE: NONE	APPROVED BY:	DRAWN BY: MAM
DATE: 10/15/97		REVISED: 7/09/09

**DRIVEWAY APRON WITH CULVERT**

STANDARD DRAWING	111
------------------	-----

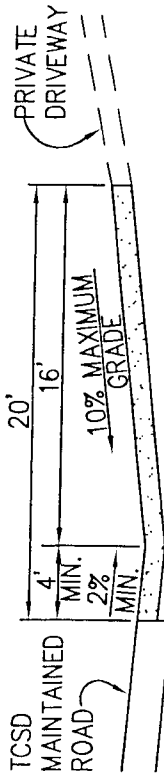

**NOTES:**

1. DRIVEWAY SURFACING SHALL BE 2" THICK (MIN.) A.C. OR 4" P.C.C. ON COMPACTED SOIL.
2. SEE TCSO STD. DRAWING #111 IF DRIVEWAY CULVERT IS REQUIRED.
3. A.C. CURB, IF PRESENT, MUST BE SAWCUT TO PROVIDE A 3' MINIMUM TRANSITION FROM 6" CURB HEIGHT TO 1-1/2" LIP ACROSS DRIVEWAY APRON. APRON MUST BE CONSTRUCTED TO PREVENT ROADWAY DRAINAGE FROM ENTERING DRIVEWAY.
4. TRANSITION FROM A.C. SWALE -- SEE TCSO STD. DRAWING #113.

**SECTION 'A-A'**

NOT TO SCALE

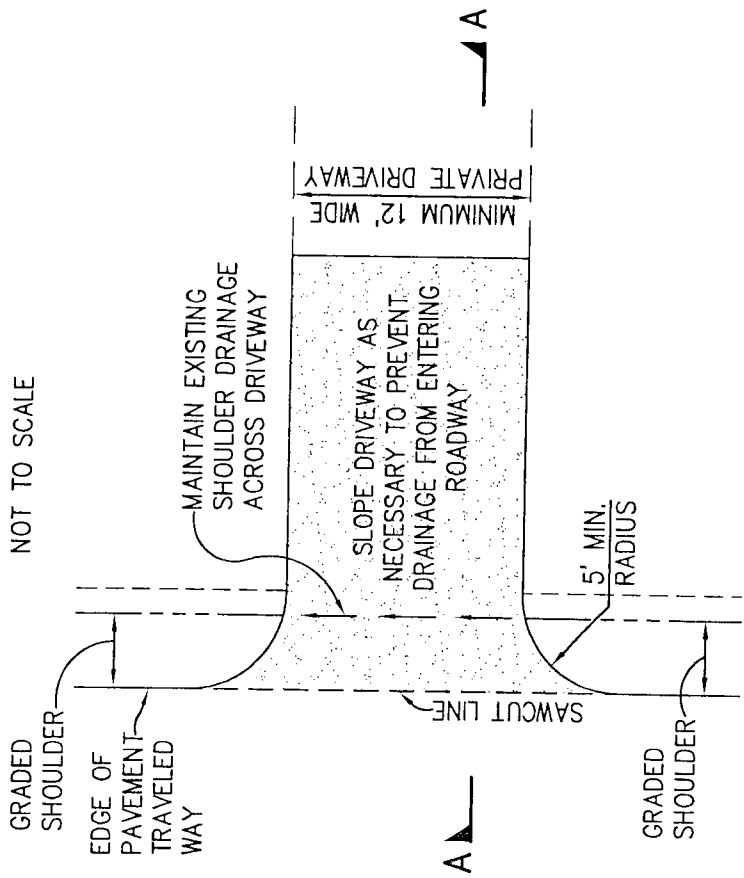

**PLAN**

NOT TO SCALE

<b>TENAJA COMMUNITY SERVICES DISTRICT</b>	
SCALE: NONE	APPROVED BY:
DATE: 10/15/97	DRAWN BY: MAM
	REVISED: 7/09/09
<b>DRIVEWAY APRON</b>	
<b>STANDARD DRAWING</b>	<b>112</b>

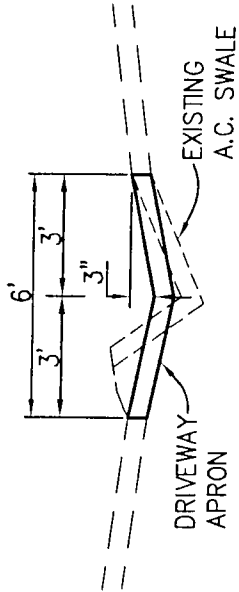

**SECTION 'A-A'**  
NOT TO SCALE

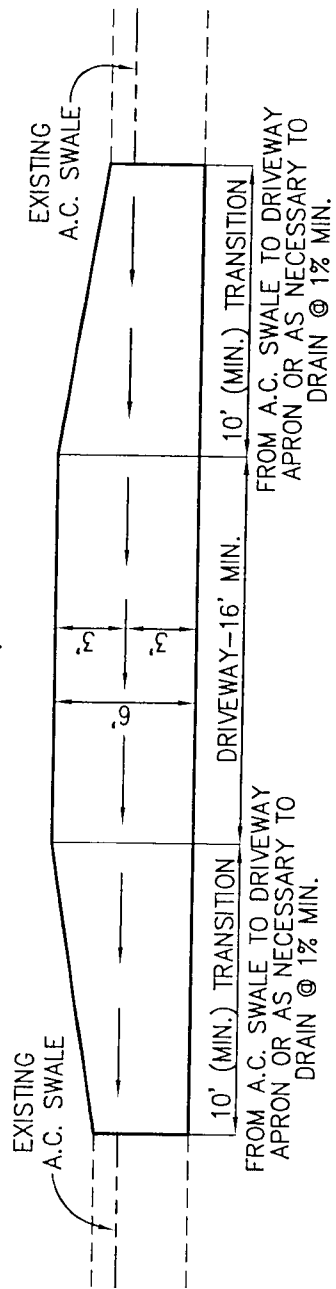

**PLAN**  
NOT TO SCALE

FROM A.C. SWALE TO DRIVEWAY  
APRON OR AS NECESSARY TO  
DRAIN @ 1% MIN.

FROM A.C. SWALE TO DRIVEWAY  
APRON OR AS NECESSARY TO  
DRAIN @ 1% MIN.

**TENAJA COMMUNITY SERVICES DISTRICT**

SCALE: NONE      APPROVED BY:      DRAWN BY: MAM  
DATE: 12/15/88      REVISED: 7/09/09

**A.C. SWALE AT DRIVEWAY**

**STANDARD DRAWING**

**113**

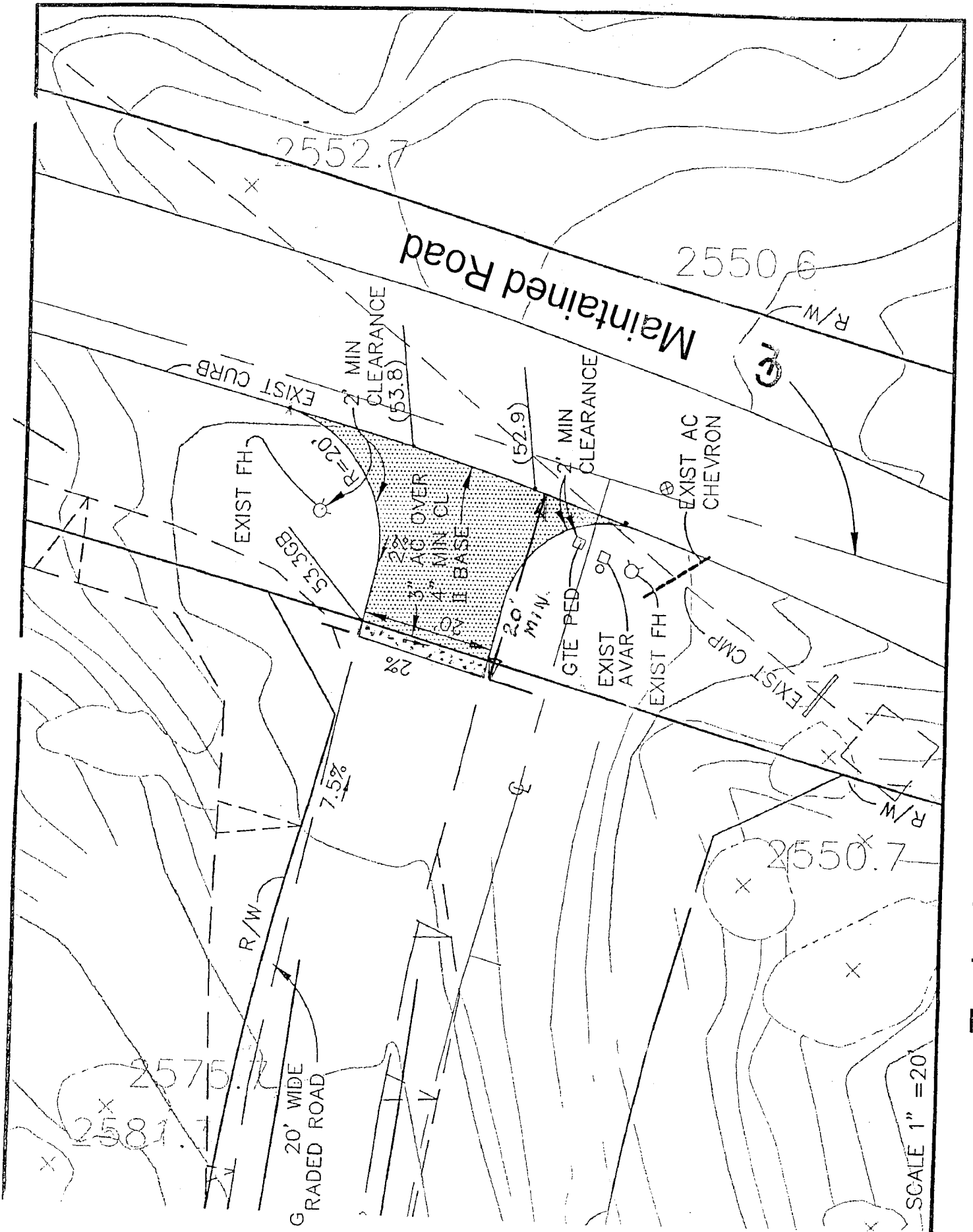

SCALE 1" = 20'

Typical Road Intersection with TCSD Road